

WAFER TYPE CHECK VALVE

FEATURES

- Design : API 6D / API 594 / ASME B 16.34
- Face to Face : API 6D / API 594
- Testing : API 6D / API 598
- Material : ASTM Specifications
- Trims : Varieties of combinations
- Soft seat for tight shut-off.
- Lesser weight, smaller size and lesser force to open.

- Optional : Replacement of conventional check valves without Pipeline modification.

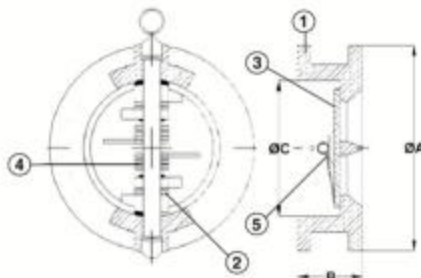

DUAL PLATE CHECK VALVES

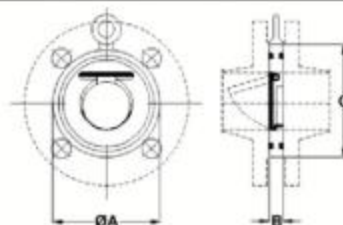

SINGLE PLATE CHECK VALVES

MATERIALS OF CONSTRUCTION

No.	DESCRIPTION	WCB	C5	LCB	CF8M
01	BODY	A 216 Gr. WCB	A 217 Gr. C5	A 352 Gr. LCB	A 351 Gr. CF8M
02	SEAT RING	WCB + 13% Cr. STEEL	WCB + 13% Cr. STEEL	A 352 Gr. LCB + SS 304	A 351 Gr. CF8M
02A	SOFT SEATED RING	EPDM / NITRILE / VITON / NEOPRENE	EPDM / NITRILE / VITON / NEOPRENE	EPDM / NITRILE / VITON / NEOPRENE	EPDM / NITRILE / VITON / NEOPRENE
03	DISC	A 217 Gr. CA15	A 217 Gr. CA15	A 352 Gr. LCB + SS 304	A 351 Gr. CF8M
04	SPRING	SS304	SS304	SS304	SS316
04B	HINGE	A 216 Gr. WCB A 217 Gr. CA 15	A 217 Gr. C5/ A 217 Gr. CA 15	A 351 Gr. CF-8 / A 352 Gr. LCB	A 351 Gr. CF8M
05	FLANGE SEAL	EPDM / NITRILE / VITON / NEOPRENE	EPDM / NITRILE / VITON / NEOPRENE	EPDM / NITRILE / VITON / NEOPRENE	EPDM / NITRILE / VITON / NEOPRENE
06	STEM SHAFT / HINGE PIN	A 276 TP 410	A 276 TP 410	A 276 TP 304	A 276 TP 316

DIMENSIONS

CLASS 150																							
WAFER CHECK VALVES						CLASS 150 DUAL PLATE CHECK & SINGLE PLATE CHECK																	
SIZE NPS (")	2	2 1/2	3	4	6	8	10	12	-	2	2 1/2	3	4	6	8	10	12	15	16	18	20	24	
SIZE DN (mm)	50	65	80	100	150	200	250	300	-	50	65	80	100	150	200	250	300	350	400	450	500	600	900
A F/F mm	19	19	19	19	19	29	29	38	A	60	67	73	73	98	127	146	181	184	191	203	219	222	
B DIA mm	104	123	136	174	222	279	339	409	B	104	123	136	174	222	279	339	409	450	513	549	606	717	
C DIA mm	60	73	89	114	168	218	273	323	C	60	73	89	114	168	218	273	323	355	406	457	508	610	

CLASS 300																							
WAFER CHECK VALVES						CLASS 300 DUAL PLATE CHECK & SINGLE PLATE CHECK																	
SIZE NPS (")	2	2 1/2	3	4	6	8	10	12	-	2	2 1/2	3	4	6	8	10	12	15	16	18	20	24	
A F/F mm	19	19	19	19	22	29	38	51	A	60	67	73	73	98	127	146	181	222	232	264	292	318	
B DIA mm	111	130	149	180	250	307	361	422	B	111	130	149	180	250	307	361	422	485	539	596	654	774	
C DIA mm	60	73	89	114	168	218	273	323	C	60	73	89	114	168	218	273	323	355	406	457	508	610	

CLASS 600																							
WAFER CHECK VALVES						CLASS 600 DUAL PLATE CHECK & SINGLE PLATE CHECK																	
SIZE NPS (")	2	2 1/2	3	4	6	8	10	12	-	2	2 1/2	3	4	6	8	10	12	15	16	18	20	24	
A F/F mm	19	19	19	22	29	38	57	60	A	60	67	73	79	137	165	213	229	273	305	362	368	438	
B DIA mm	111	130	149	193	266	320	400	457	B	111	130	149	193	266	320	400	457	492	565	612	682	790	
C DIA mm	60	73	89	114	168	218	273	323	C	60	73	89	114	168	218	273	323	355	406	457	508	610	